

MANUAL

AcquaSPA

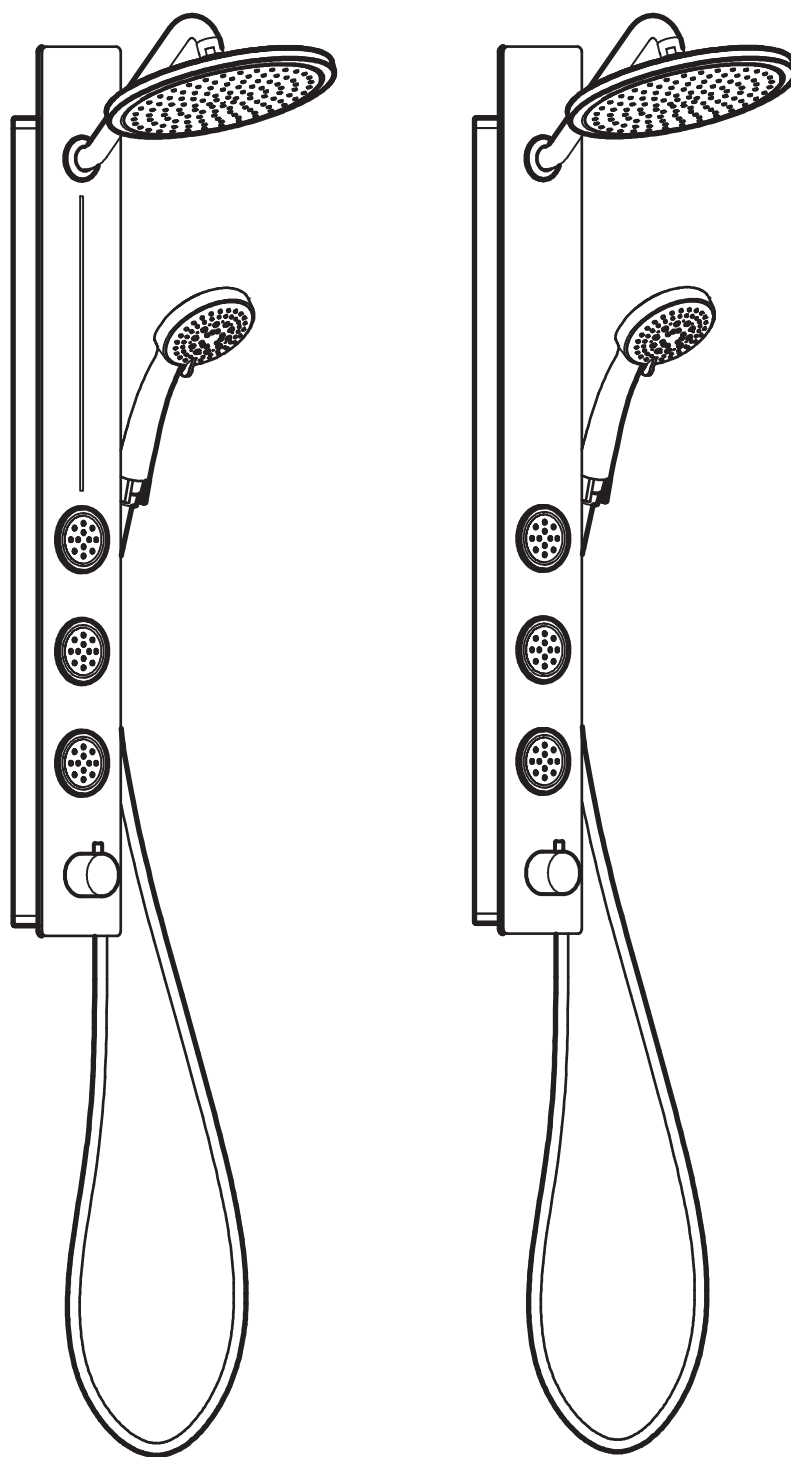

FORNIO
ACQUA®

SL31****

TABLE OF CONTENTS

General.....	2	Operation.....	8
Tools Required.....	2	Trouble Shooting.....	9
Exploded Diagram.....	3	Care and Maintenance.....	9
Pre-Assembly.....	4	Spare Parts List.....	10
Preparation.....	5	Warranty.....	11
Pre-Installation.....	6	Customer Care.....	12
Installation.....	7		

1. GENERAL

READ AND SAVE THESE INSTRUCTIONS

- Inspect this product before proceeding. Unpack the contents of the package and check the components for chips, scratches, cracks, dents or scuff marks. If any damage is noticed, do not install.
- Use this product only in the manner intended by the manufacturer. If you have any questions, contact the manufacturer.
- Installation work and plumbing must be done by qualified person(s) in accordance with all applicable codes and standards.
- Protect the entire surface during installation.



CAUTION: Always wear safety goggles and gloves during installation to prevent personal injury

2. TOOLS REQUIRED

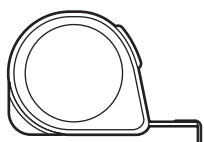

Measuring tape

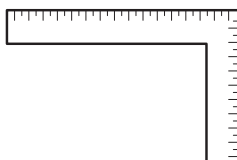

Carpenter's square



Wrenches

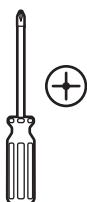

Phillips screwdriver

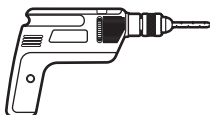

Electric Drill
with 1/4" Masonry
Drill Bit

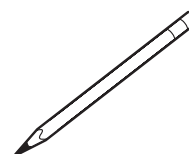

Pencil



Safety gloves



Safety goggles



Level

3. EXPLODED DIAGRAM

Part	Description	Qty
1	Hex Key	1
2	Thread Seal Tape	1
3	Mesh Gasket	1
4	Rubber Washer (1/2")	3
5	Check Valve (Pre-installed)	1
6	Long Brass Connector (55mm)	1
7	Short Brass Connector (28mm)	3
8	Stainless Steel Mounting Bracket	1
9	Stainless Steel Washers	2
10	Nut	1
11	Wall Anchors	3
12	Bottom Bracket	1
13	Screws and Washers	3
14	Stainless Steel Cover (Pre-installed)	1
15	Top Cover (Pre-installed)	1
16	Shower Arm	1
17	Elbow Fitting (Pre-installed)	1
18	Elbow Fitting (Pre-installed)	1
19	Nut (Pre-installed)	1
20	Rubber Washer (1/2") (Pre-installed)	1
21	Shower Head	1
22	Restrictor (Pre-installed)	1
23	Aluminium Plate Cover	2
24	Shower Column	1
25	Handheld Shower Head	1
26	Handheld Bracket (Pre-installed)	1
27	Jets	3
28	Check Valve (Pre-installed)	1
29	Handheld Hose	1

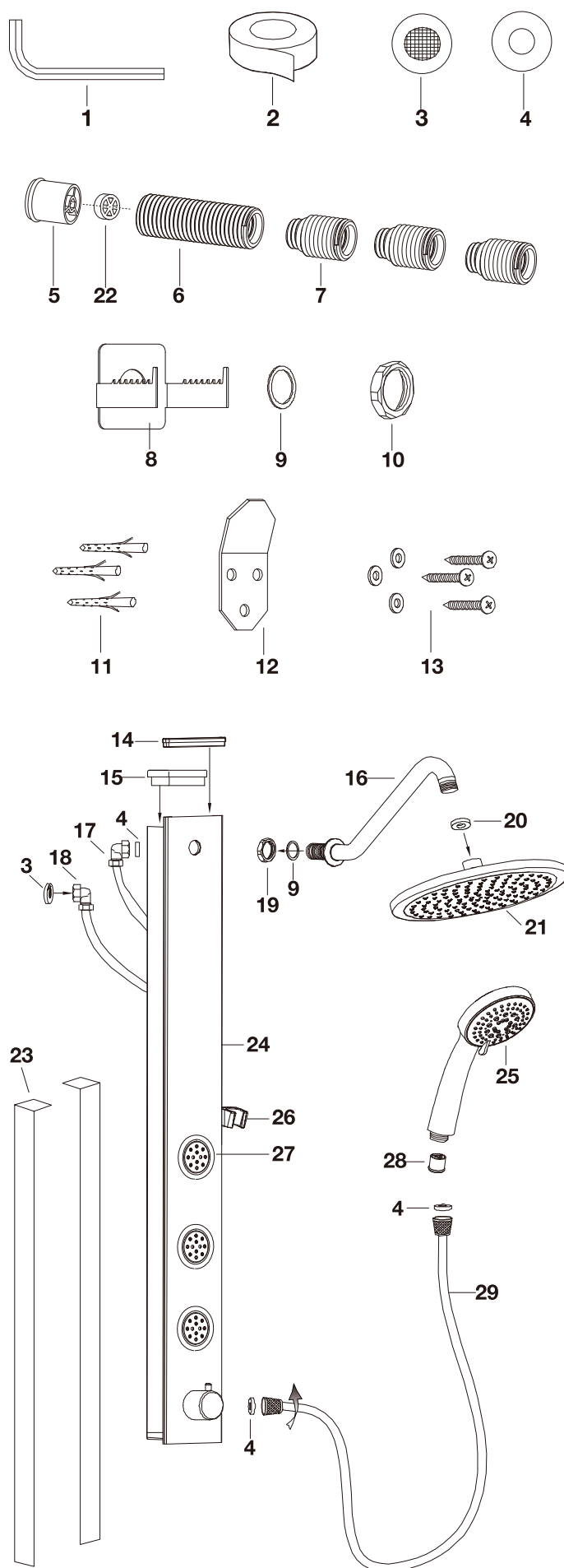

**If you find any part missing,
please call: (866) 231 8893
Or email us at:
mysupport@fornoworld.com
Please do not return this
AcquaSPA to the store
before calling**

4.PRE-ASSEMBLY

BEFORE YOU BEGIN:

This product can be installed on both flat and uneven surfaces of up to 1-1/2" (38mm), (see 4A)

This unit might not be suitable for installation with some fiberglass or acrylic showers.

This product is designed to connect to your existing plumbing. There is no need to take out your current valve or change it.

Your shower valve, diverter valve or diverter tub spout will be used in its current position and will operate as before (see 4B).

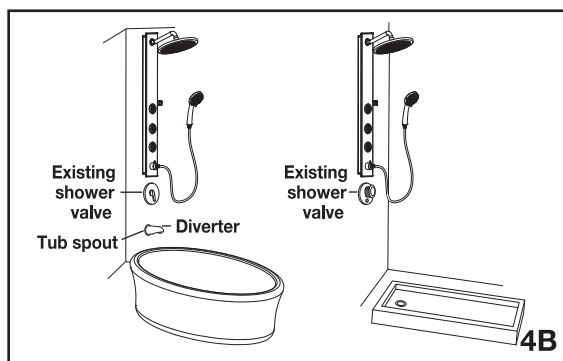
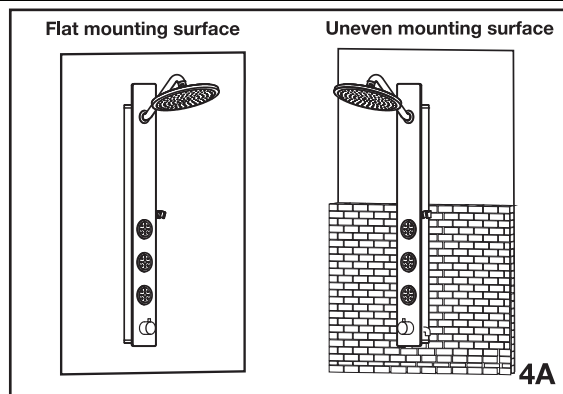

SHOWER ARM and HEAD INSTALLATION

Remove the Top Cover (15) and the Stainless Steel Cover (14) from the Shower Panel Body (24), (see 4C).

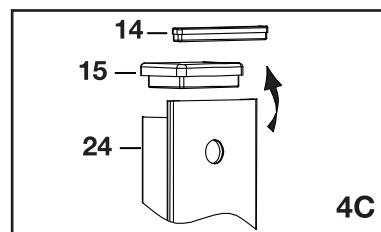

Remove the Nut (19) that is pre-installed in the Shower Arm (16), (see 4D).

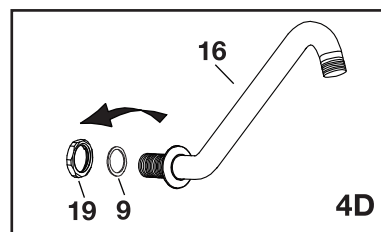

Insert the Shower Arm (16) into the Shower Panel Body (25) and secure it with the Nut (19), (see 4E).

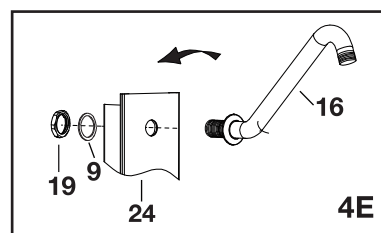

Place the Rubber Washer (4) onto the Elbow Fitting (17). Make sure that you are using the Elbow without the restrictor pre-installed. Connect the Elbow Fitting (17) to the Shower Arm (16), (see 4F).

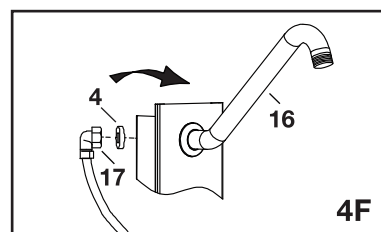

Check that the Rubber Washer (20) that is pre-assembled in the Shower Head (21) is in place. Attach the Shower Head (21) on to the Shower Arm (16), see 4G).

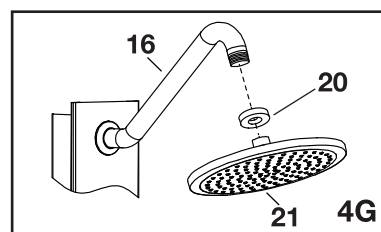

5. PREPARATION

NOTE:

Make sure that your shower valve is closed at all times from now until the testing is required.

Disassemble your existing shower head (A) . Pull away from the wall cover (B) that is in the area where the shower arm (C) meets the wall (see 5A).

Mark clearly on your existing shower arm, the level at which the wall meets the shower arm (see 5B).

Remove your existing shower arm (C) from the wall using a wrench and turning it counter-clockwise . DO NOT DISCARD YET.

IMPORTANT

Put Thread Seal Tape (2) on the end of the Long Brass Connector (6) that has the White Check Valve (5) (see 5D).

Align the thread sealed end of the Long Brass Connector (6) with the threaded end of the recently removed old shower arm . The open end of the long brass connector should extend past the mark drawn on the shower arm by 5/8" to 1-1/8" (16 to 29 mm) as shown in figure 5E. If it does not, extend it with Short Brass Connectors (7) until it does as shown in figure 5F.

IMPORTANT

Using the provided Hex Key (1), install the assembled brass connector, see 5G, making sure that the end where you placed the thread-seal tape (where the check valve is) goes towards the wall where the old shower arm was.

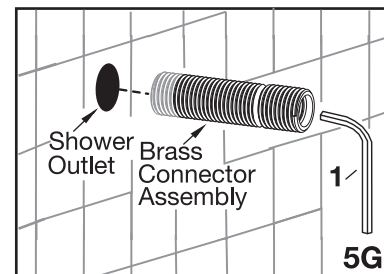
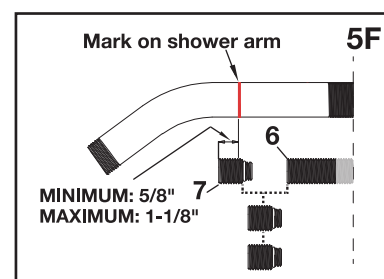
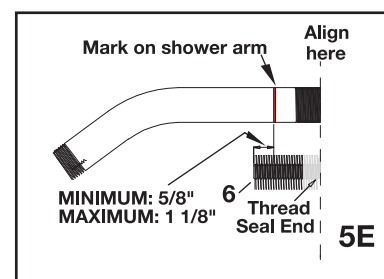
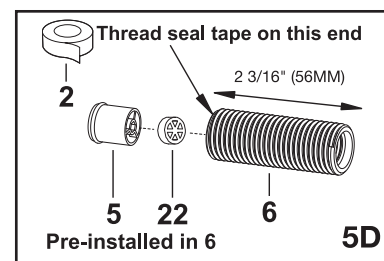
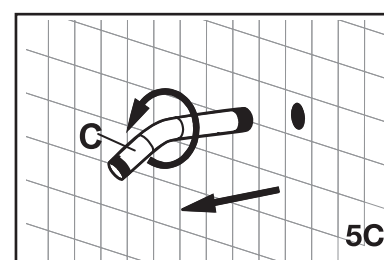
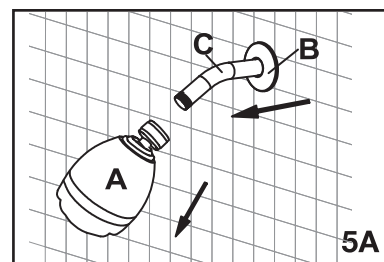

6. PRE-INSTALLTION

Clean the wall around the brass connector assembly thoroughly with a dry cloth . Peel the paper backing from the double sided tape on the Stainless Steel Mounting Bracket (8) .

Place the Stainless Steel Mounting Bracket (8) on the brass connector assembly. Ensure that both arms of the bracket are aligned horizontally with a carpenter's level before proceeding and adhere upright to the wall. Secure and tighten the Nut (10) on brass assembly using one or two of the Stainless Steel Washers (9), if required, (6A).

NOTE:

Bracket (8) allows for mounting this unit on flat walls or on walls that have a shower surround or tiles with a step of up to 1-1/2" (38 mm).

With a dry rag, thoroughly clean the wall between the brass connector and the shower valve. Also thoroughly clean a 4" x 4" area of the wall approximately 22 1/2" below the brass connector (see 6B). Use alcohol if so required.

Layout Bottom Bracket (12) mounting location by drawing a "T" as shown in 6B and 6C.

Use the Bottom Bracket (12) to layout the location of the screw holes (see 6D). Poke small holes in the double sided tape if needed for marking.

NOTE:

This product can be secured to the wall with or without the use of screws.

If you prefer NOT to use wall screws to secure the Bottom Bracket (12) to the wall, simply peel off the backing of the Bottom bracket Double Sided Tape (12) and secure it to the wall by first aligning it with previously drawn layout holes and pressing it firmly into the wall for 5 to 10 seconds (see 6E). Skip next step and go to Section 7. INSTALLATION.

If you'd like to use wall screws to secure Bottom Bracket (12) to the wall, drill three 1/4" holes in previously marked locations . Insert Wall Anchors (11) into pre-drilled holes . Peel off the backing of the Bottom Bracket (12) double sided tape and secure it to the wall with Screws and Stainless Steel Washers (13), (see 6F).

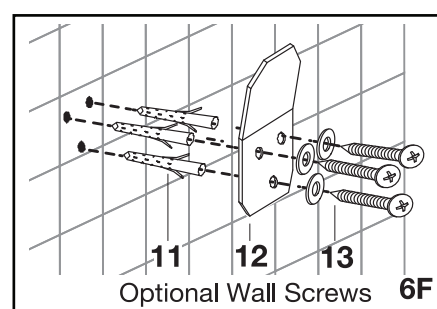
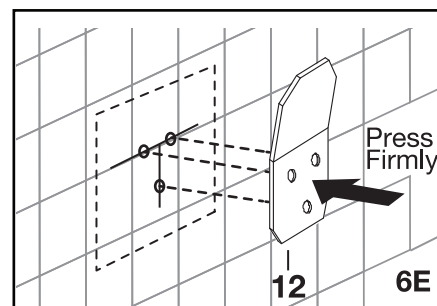
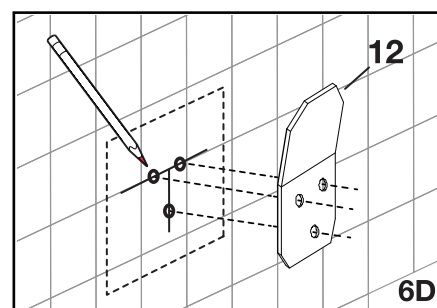
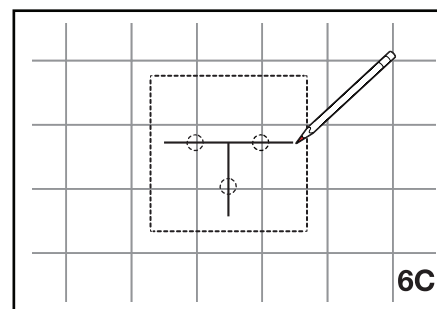
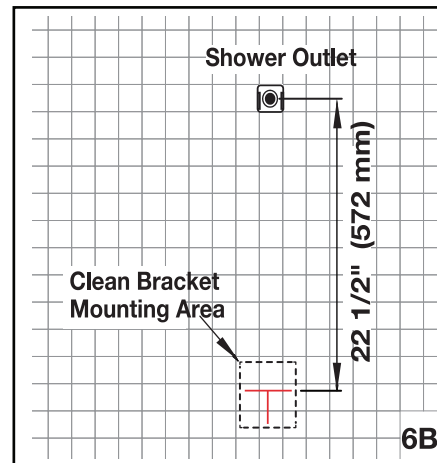
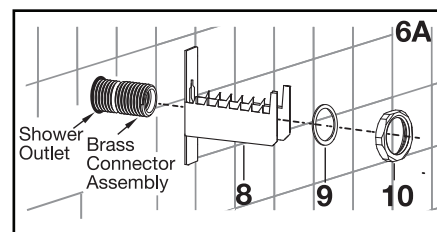

7. INSTALLTION

Connect Elbow Fitting (18) that has the pre-installed restrictor to brass connector assembly using Rubber Washer (4) (see 7A).

Hang first the top of the Shower Column (24) on the Stainless Steel Mounting Bracket (8) through the holes in the Shower Column. Then hang the Shower Column on the Bottom Bracket (12) (see 7B). Adjust by lifting slightly and pushing the panel in so that it is tight against the wall.

Install Top Cover (15) and the Stainless Cover (14) on the Shower Column (24) (see 7C).

Check to see that Check Valve (28) is pre-installed in Handheld Shower (25). Attach long Flexible Shower Hose (29) to the side of the Shower Column (24) and to the Handheld Shower (25) with Rubber Washers (4) and (3) (see 7C).

NOTE:

Make sure that none of the hoses are kinked after installation. Check water connections for proper flow and leaks. Do not forget to use the rubber washers to prevent leaks from the connections. If you find that the water pressure or volume is low, clean the Mesh Gasket (3).

IF YOU HAVE A STALL OR TILES WITH AN UNEVEN SURFACE

Measure the length of the gap between the top of the shower panel and the stall (see 7D).

Cut both Aluminum Covers (23) with scissors to desired length. Remove the paper backing from the Aluminum Covers (23) then stick them on the gap from the panel to the wall (see 7E). Caulk if desired between the Aluminum Covers (23) and the wall.

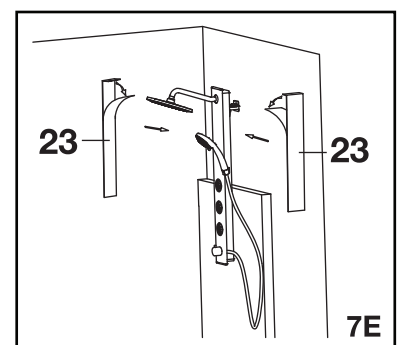
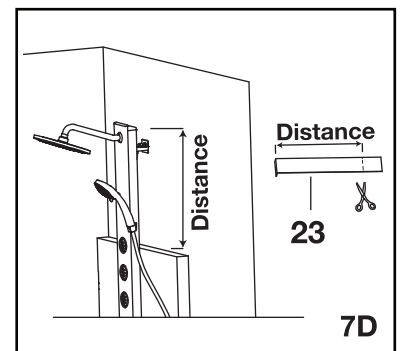
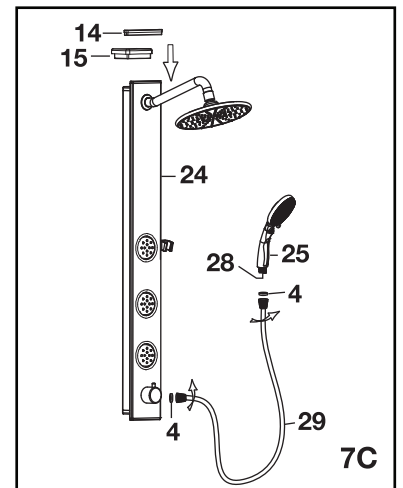
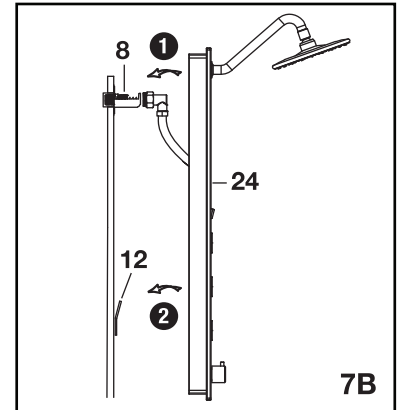
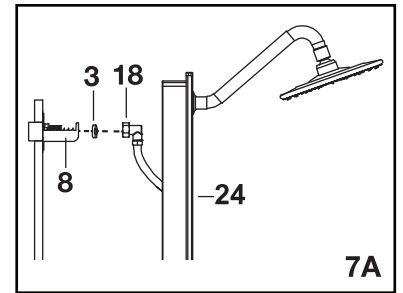

8. OPERATION

To use the new **AcquaSPA** first turn on and adjust the temperature on the existing shower valve then redirect the water to your new **AcquaSPA** using the diverter (see 8A).

Use the Selector Switch (See 8B) to choose between the showering use options:

Position a - Shower Head

Position b - Body Jets

Position c - Handheld Shower

Position d - Combines Shower Head and Handheld Shower

Position e - Combines Handheld and Body Jets

Position f - Combines Body Jets and Shower Head

Use your existing shower valve to adjust water temperature and pressure.

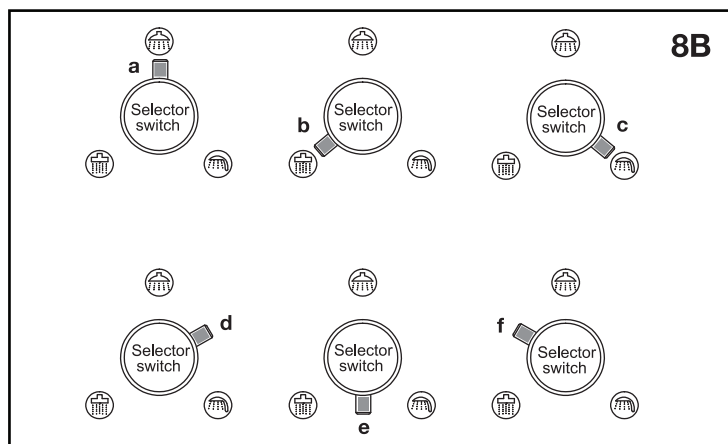
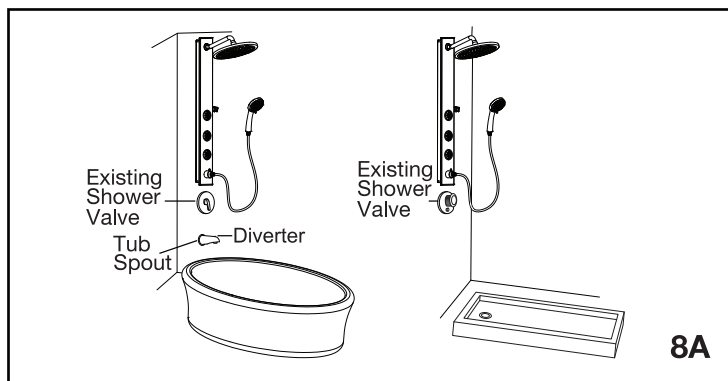

SensoTEMP Units

SensoTEMP units have an internal generator that generate power for the **SensoTEMP** lights based on the internal water pressure. There are NO BATTERIES required to make the **SensoTemp** lights work.

The light will be:

- Blue up until the water temperature is 32°C (90°F)
- Purple between 32°C (90°F) and 42°C (108°F)
- Red if the water temperature is between 42°C (108°F) and 50°C (122°F)
- Flashing red if the water temperature is over 50°C (122°F)

SensoTEMP units SL31M*-L* have a **SensoTEMP** strip above the Body Jet area.

SensoTEMP units SL31B*-L* have **SensoTEMP** Body Jets.

9. TROUBLESHOOTING

- If there are leaks, make sure that the Rubber Washers (3) and (4) are properly installed.
- If there is no water flow, check the Brass Connector (6) to make sure that it has not been installed incorrectly. Refer to Diagrams 5D and 5G in the PREPARATION section.
- If the Check Valve (5) is installed correctly and there is still no water flow, take your **AcquaSpa** off the wall, loosen the Elbow Fitting (18) and check if the Restrictor (22) is blocked with debris. Take the restrictor off, clean with water and reinstall.
- If you find that water pressure or volume is low, clean the soft rubber tips of the Shower Head (21) and the Handheld (25) by rubbing with your fingers to loosen any mineral deposit.
- If you still find that water pressure or volume is low, clean the Mesh Gasket (3).

10. CARE and MAINTENANCE

- After use, rinse the shower column with water using the handheld shower to remove any soap deposits. Should water spots occur, clean with a mild solution of vinegar and water followed by a thorough rinse.
- Use liquid soap, a general household cleaner, or a weak solution of vinegar and water for regular cleaning. Never use abrasive cleaners as they will scratch the finish.
- Never use abrasive cleaners as they will scratch the finish.
- Clean the soft rubber tips of the Shower Head (20) and the Handheld (25) every few months (depending on your water hardness) by rubbing with your fingers to loosen any mineral deposits.

11. SPARE PARTS

Spare Kit No.	Spare Kit Code	Spare Kit Name	Parts Included	Part Name	Qty
N/A	N/A	N/A	1	Hex key	1
N/A	N/A	N/A	2	Thread seal tape	1
A	SL31-A	Washer Kit	3	Mesh gasket	1
			4	Rubber washer (1/2")	3
B	SL31-B	Connector Kit	5	Check valve (pre-installed)	1
			22	Restrictor (pre-installed)	1
			6	Long brass connector (55mm)	1
			7	Short brass connector (28mm)	3
C	SL31-C	Mounting Bracket Kit	8	Stainless steel mounting bracket	1
			9	Stainless steel washers	1
			10	Nut	1
D	SL31-D	Bottom Bracket Kit	11	Wall Anchors	3
			12	Bottom bracket	1
			13	Screws and washers	3
E	SL31-E	Cover Kit	14	Stainless steel cover	1
			15	Top cover	1
F	SL31-F	Shower Arm Kit	9	Stainless steel washer	1
			16	Shower arm	1
			19	Nut (pre-installed)	1
G	SL31-G	Shower Head Kit	20	Rubber washer (1/2") (pre-installed)	1
			21	Shower head	1
H	SL31-H	Stall Kit	23	Aluminium plate cover	2
N/A	N/A	N/A	24	Shower column	1
J	SL31-J	Handheld Shower	25	Handheld shower head	1
			28	Check valve (pre-installed)	1
K	SL31-K	Hose	29	Hand Held Hose	1

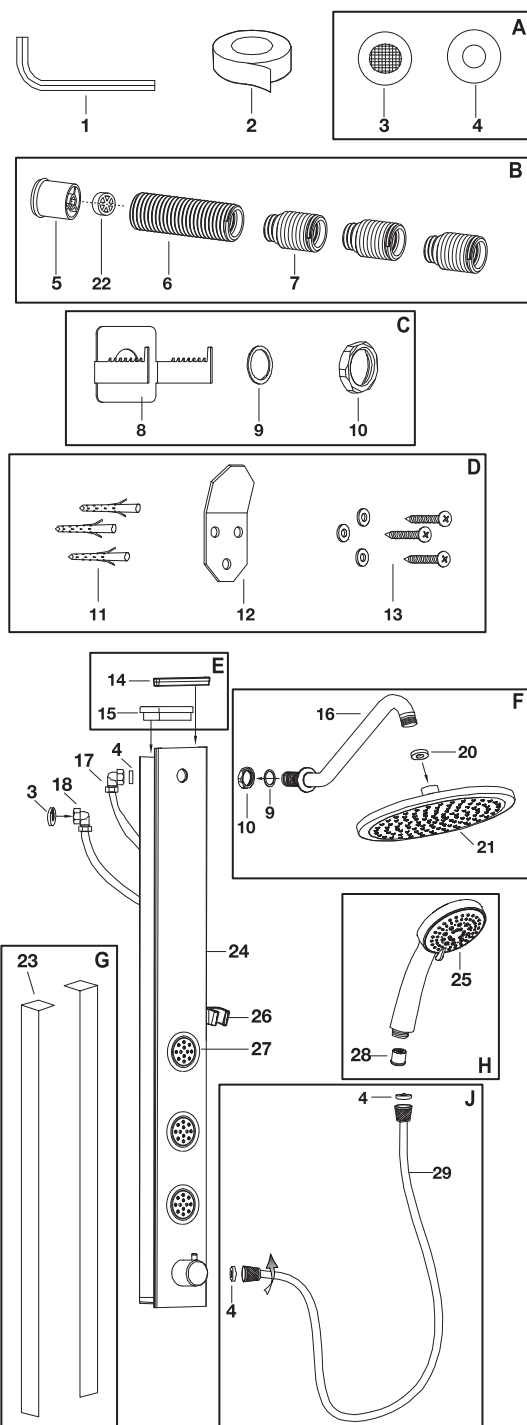

If you find any part missing please call: (866) 231 8893
 Or email us at: mysupport@fornoworld.com
 Please do not return this AcquaSPA to the store before calling

Warranty

CTM Maison Elite Inc. grants this limited warranty to the original purchaser of this Shower Panel from the date of purchase. Proof of purchase is required when requesting any warranty assistance.

Limited One Year: CTM Maison Elite Inc. warrants that all parts, to be free from defects in workmanship and material at the time of manufacture for a period of one year. We agree to send a replacement part without charge or at our option replace it with a comparable or superior part at our sole discretion.

To the extent permitted by law, CTM Maison Elite Inc. disclaims any and all warranties, including but not limited to those of merchantability and fitness for a particular purpose. There is no other express warranty. The duration of any implied warranty which cannot be disclaimed is limited to the period specified in the express warranty. Some states do not allow a limitation on how long an implied warranty lasts. The time limitation may not apply to you. Some states do not allow the exclusion of incidental or consequential damages, so the above limitation may not apply to you. This warranty gives specific legal rights. You may also have other rights which vary from state to state. The retailer shall not be liable for incidental, consequential, or damages arising out of or in connection with product use or performance except as may otherwise be accorded by law.

This limited warranty is non-transferable and only to the original purchaser of this Shower Panel and will be void if unit is removed from its original installation.

This warranty does not cover: ordinary wear and tear, minor cosmetic blemishes, batteries, light bulbs, refurbished units, Shower Panels that are not owned by the original purchaser, acts of God, changes in finish including rusting, pitting, corroding, tarnishing, or peeling.

Damage to any part by accident, misuse, abuse, improper installation, dents and/or scratches incurred during shipping, handling, or installation, bends or warping caused by forced connections, over-tightened fittings, and/or inadequate support during installation, improper care and maintenance, failure to follow the instructions in the enclosed manual or any modification to the unit are not covered by this warranty.

All costs of shipping parts, removing, repair labour and reinstalling the product are not covered by this warranty. Please do not ship your Shower Panel or any parts to CTM Maison Elite Inc. Shipment will not be accepted.

This warranty supersedes all prior warranties.

FOR WARRANTY PURPOSES PLEASE REGISTER YOUR PRODUCT.



ASME A112.18.1
CSA B125.1
IGC154

Customer Care

Thank you for purchasing a FORNO ACQUA product. Please read the entire instruction manual before operating your new appliance for the first time. Whether you are an occasional user or an expert, it will be beneficial to familiarize yourself with the safety practices, features, operation and care recommendations of your appliance. Both the model number and serial number are listed on the product. For warranty purposes, you will also need the date of purchase. Record this information below for future reference.

SERVICE INFORMATION

Model Number

Use these numbers in any correspondence or service calls concerning your appliance.

Serial Number

If you received damaged appliance, immediately contact the dealer (or builder) that sold you the appliance.

Date of Purchase

Purchase Address & Phone

Save time and money. Before you call for service, check the Troubleshooting Guide. It lists the causes of minor operating problems that you can correct yourself.

CUSTOMER SERVICE

Keep the instruction manual handy to answer your questions. If you don't understand something or you need more assistance, please call our Customer Service: 1-866-231-8893

Or email: mysupport@fornoworld.com

Our contact: CTM Maison Elite Inc.

11420 Albert Hudon, Montréal, Québec H1G 3J6, Canada

The instruction manual can be downloaded from www.fornoworld.com

Made in China